

## Chilko 57 deck mount faucet

Series : **Authentik Signature**

Nominal dimensions: **57" x 34" x 22" [144.8 cm x 86.4 cm x 55.9 cm]**

Seats : **1**

Product code: **CH57DMF**

Draft revision : **2023082508103**

Lumbar support : no

Arm rests : no

Low-profile available : no

### Draft and specs

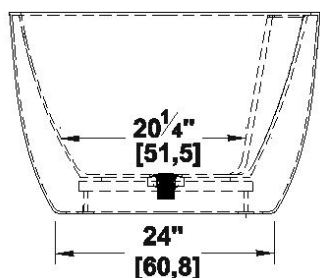
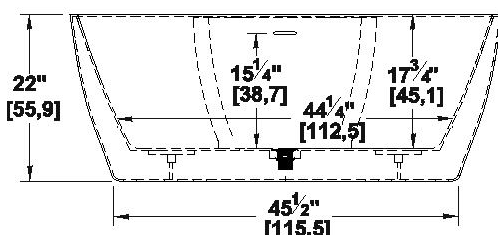
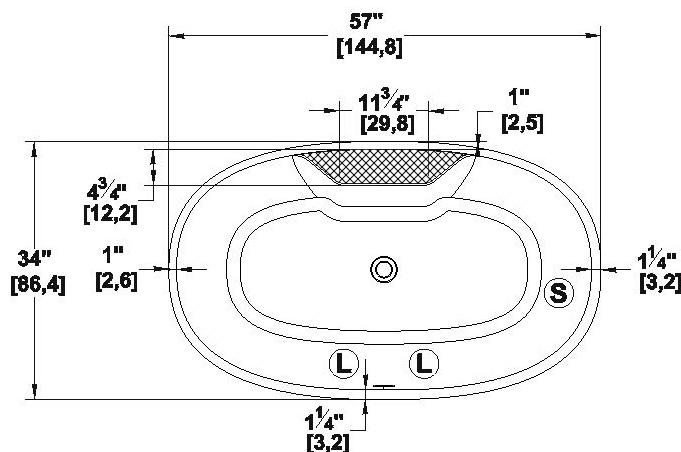

### Additional(s) note(s)

Handmade product, edge width may be uneven and vary. The overflow is factory installed, the drain is included but not installed. When ordered with AeroMassage, blower must be remote mounted. If system, delivered with keypad not installed and remote control is included.

### Specifications

Capacity: **46 IMP Gal. / 59.9 US Gal. / 209.1 liters**  
AeroMassage™: **40 Easy Clean™ air jets**  
Super AeroMassage™: **unavailable**  
Comfort Air™: **unavailable**  
Characteristics: **One-piece freestanding bath**

### Remarks

All measures have a precision of  $\pm 1/4"$  (0,63cm)  
If a measure is present on one side only, part is symmetrical  
\*internal dimensions taken at 4" (10cm) from bath bottom  
\*capacity is measured by filling the bath to 1-1/2" under the overflow

### Available models

Soaker ☒  
Comfort Air™ ☐  
AeroMassage™ ☒  
Super AeroMassage™ ☐

### Available recommended options

Front skirt:  
Recommended drain: Incl. INF101M (White finish)  
Tile flanges: unavailable  
Floating remote control: included if ordered with system  
Linear overflow: Integrated

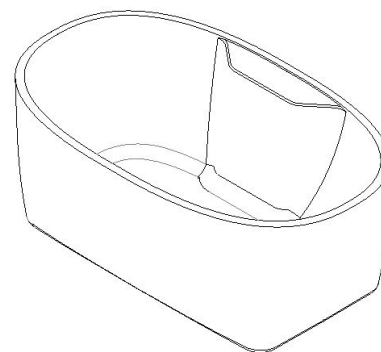

### Legend

**S** Blower **L** Chromotherapy light  
**P2** Grab bar **C** Keypad



Recommended faucets drilling location\*

Deck cut-out line - - - - -

*\*It is possible to install the faucets elsewhere on the product. The installer must verify that there are no piping or wires before drilling.*

**IMPORTANT NOTE:** Specifications, dimensions and models are subject to change.

Visit our website <http://www.oceania-attitude.com> to access up-to-date dimensions and information. In all cases, information on the website is the most up-to-date.

### Head office

591, avenue des Entreprises  
Thetford Mines, Quebec  
CANADA G6H 4B2

### Contact numbers

Phone : 1-877-332-4224  
Fax : 1-866-460-4334

### Internet

Web : <http://www.oceania-attitude.com>  
Email : [info@bainsoceania.com](mailto:info@bainsoceania.com)